

I-30 and BAIRD FARM RD. DETOUR

TRAFFIC CONTROL PLAN

(weather permitting)

START: Sep. 11 1:30 a.m.
END: Sep. 11 5:00 p.m. (est)

WHY: Final phase of the Baird Farm bridge to be completed.

WHAT: I-30 mainlanes will be reduced to one lane and detoured in advance of Baird Farm Road/Legends Way. The Baird Farm Road/Legends Way bridge will be closed.

I-30 eastbound traffic will exit Nolan Ryan Expressway, follow the eastbound frontage road and re-enter I-30 east of Ballpark Way.

I-30 westbound traffic will exit Ballpark Way, follow the westbound frontage road and re-enter I-30 west of Baird Farm Road.

Baird Farm Road/Legends Way through traffic is encouraged to use Ballpark Way, FM 157/Collins Street or Center Street.

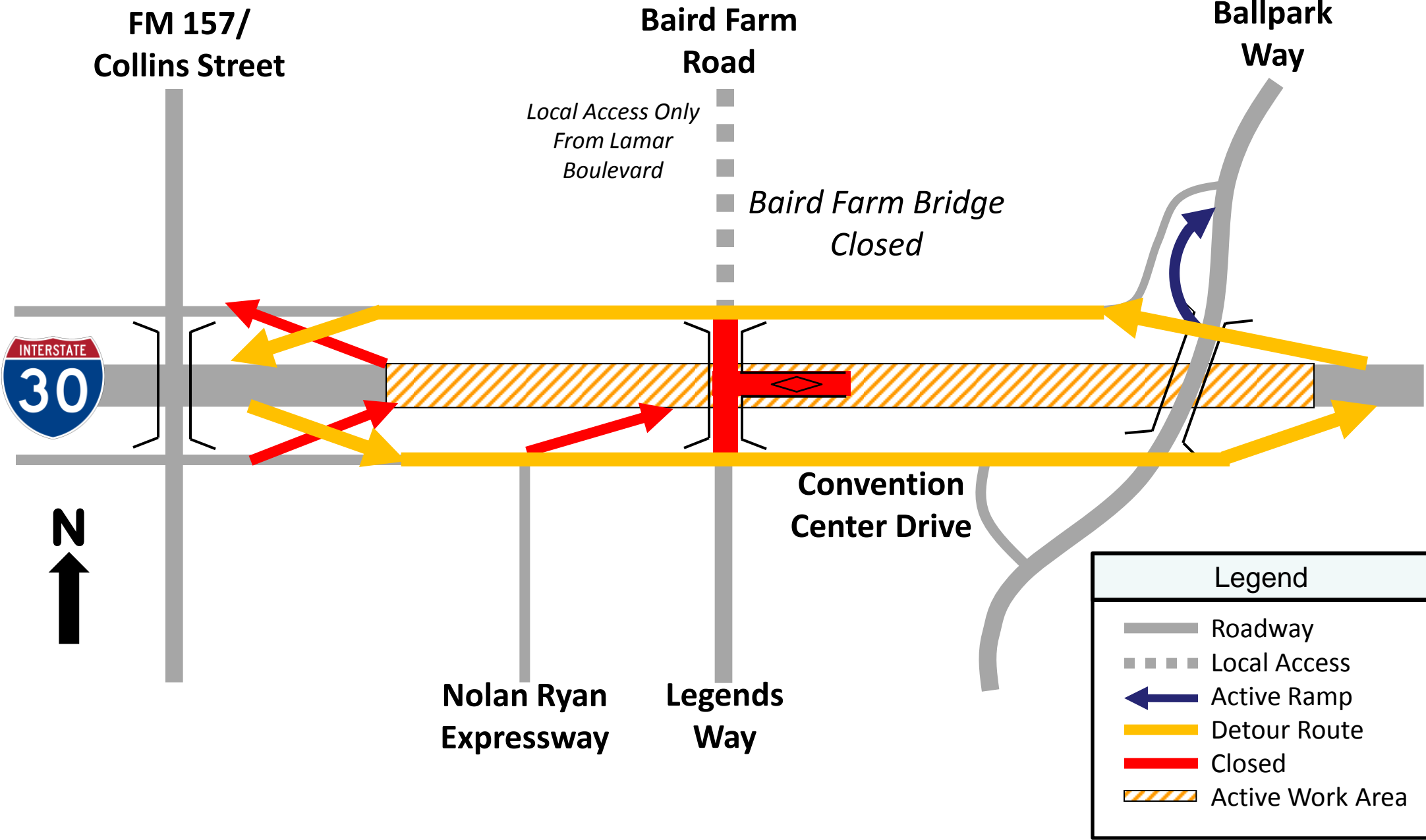

TRAVEL DIRECTION	ALTERNATE EXITS	ALTERNATE ENTRANCES
East	Cooper Street or Center Street	SH 360/Six Flags Drive
West	SH 360/Six Flags Drive	Center Street

Legend

- Roadway
- Local Access
- Active Ramp
- Detour Route
- Closed
- Active Work Area



Information Provided By:
 I-30 MOBILITY TASK FORCE
keep30moving.org
 817.462.0505